



**Washington  
Health**  
Foundation

## Foundation Focus - Winter 2025

*Furthering the Mission of Washington Health Since 1983*



**Photo:** Foundation Board - L to R: Cathy Avon, Sophia Ahmad, Eileen Riener with CEO, Kimberly Hartz & Craig Silcox

### From the Desk of the Executive Director



In the spirit of the New Year, the Foundation is pleased to announce a name change to **Washington Health Foundation**, aligning with the

healthcare system's brand transition to **Washington Health**.

UCSF-Washington Cancer Center, a 3T MRI, outpatient palliative care, behavioral health, trauma equipment, and much more.

Our Legacy Society for Planned Giving continues to grow! There are 12 families who have shared with us an intention to include the Hospital in their Will or estate plans. If you are interested in learning more about planned giving, join us for a free **charitable giving &**

The new brand better reflects Washington's evolution from a community hospital to a health system with a hospital, foundation, medical group, ambulatory care sites, and award-winning specialty services. For more details, visit [www.washingtonhealth.com](http://www.washingtonhealth.com).

Looking ahead to 2025, we are focused on expanding our impact on healthcare in our community. With the support of our trustees and members, the Foundation continues to grow its philanthropic programs to better align with patients' immediate and future needs. In addition to increasing our staff size through the addition of a major gifts officer this spring, the Foundation is working closely with leadership to enhance our mission, vision, and structure to better support the Hospital's needs now and into the future.

At the **Annual Meeting of the Foundation**, we welcomed a new trustee and seven new members, each bringing valuable expertise. Trustees also approved the **largest annual disbursement in our history** - \$5,304,201.07- for projects including the construction of the

**estate planning seminar on March 11th** at 5pm.

We're also gearing up for the **38th Annual Golf & Bocce Tournament** at the Club at Castlewood on Monday, May 12th. Plans for the **39th Annual Top Hat Gala** on October 11th are underway, so please save the dates! Let us know if you'd like to volunteer, serve on an event committee, or learn more about the Foundation's work.

**Thank you** for your ongoing support of the Washington Health Foundation. Your involvement plays a vital role in helping us provide exceptional care to Washington Health patients and improve the health and wellness of those we serve. Together, we are making a meaningful difference in the lives of individuals and families, locally and beyond Alameda County.

With gratitude,

*Sarah G. Gamski*  
Executive Director  
Washington Health Foundation

## Upcoming Foundation Events

- Tuesday, March 11th, 5pm -Estate Planning/Charitable Giving Seminar in-person and on zoom
- Wednesday, March 19th, 10am - Founders & Friends Coffee with CEO, Kimberly Hartz
- Monday, May 12th - 38th Annual Golf & Bocce Tournament

## 2025 Annual Donation - Your Impact on Patient Care

In January, the Trustees voted to disburse **\$5,304,201.07** to Washington Health, aimed at bolstering a variety of essential healthcare programs. This substantial funding will support initiatives ranging from oncology services to the acquisition of advanced medical equipment, including a brand-new 3T MRI machine, among other critical enhancements.



A noteworthy portion of this funding, over **\$4M**, was specifically allocated to support the construction of the new **UCSF-Washington Cancer Center** located on the Fremont Campus. This state-of-the-art facility is set to revolutionize cancer care in the region, providing patients with access to cutting-edge treatment options and comprehensive support services. Trustees authorized the disbursement of **\$580,000** to facilitate the purchase of a **state-of-the-art 3T MRI machine**. This ultra-high-resolution imaging device is poised to significantly improve patient outcomes by enabling more detailed readings, which can lead to earlier and more accurate diagnoses. Introducing this advanced technology reflects Washington Health's commitment to providing the highest standard of care to patients.

In 2024, support from our community has been invaluable, with over **\$160,000** disbursed to Washington Health to assist in acquiring vital equipment and training programs for the Level II Trauma Center, the ICU, CCU and Emergency Department. This funding has been directed towards a variety of essential training and tools, including the Cortrack EAS System for patient nutrition, a Rapid Infuser Belmont for blood infusions, an Omni Retractor set and instrument tray for general surgery, as well as Cardiac Nursing Education Training Courses for staff professional development. Additional purchases include 3 Vaporizers for the operating rooms and a Barium Swallow Chair for rehabilitation services, among many other initiatives. The Foundation is grateful to the community for making this support possible!

---



## Washington Hospital Healthcare System Rebrands as Washington Health

Washington Hospital Healthcare System is proud to announce the beginning of a phased brand transition to **Washington Health**. The new brand reflects Washington's evolution from a community hospital to a health system with a hospital, medical group, ambulatory care sites, and award-winning specialty services in trauma, orthopedics, neurosurgery, cardiovascular surgery, oncology, maternal and child health, and neonatal intensive care. The health system has also refreshed its mission, vision, and values with the new name and the tagline Embracing Care.

*"This transformative moment honors our evolution to an integrated health system while preserving our commitment to the community as an independent, community-based provider,"* said Kimberly Hartz, Chief Executive Officer. *"The new identity represents the seamless integration of our services and aligns with our mission, vision, and values, ensuring every interaction reflects our dedication to delivering high-quality, patient-centered care."*

**Mission:** Deliver exceptional, accessible, and personalized care to enhance the health and well-being of our diverse community.

**Vision:** Be the trusted first choice for care, where everyone does their best work.

**Values:** Excellence | Patient-Centered Care | Compassion | Respect | Integrity

Discover more at [washingtonhealth.com](https://www.washingtonhealth.com), and through **Facebook**, **X** (Twitter), **LinkedIn** and **Instagram**, and watch the video below





---

## **Last Chance to Make a Lasting Impact** ***Help Us Cross the Finish Line!***

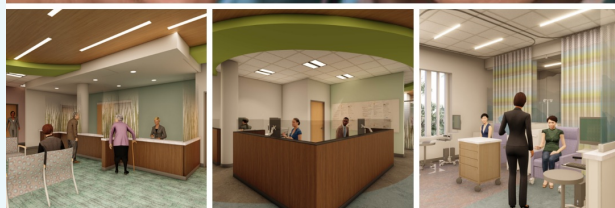

As we enter the final weeks of the **UCSF – Washington Cancer Center Campaign**, we express our deepest gratitude for your unwavering support through the years. As the philanthropic arm of the Washington Health community, we work hard to raise awareness and secure valuable funding in support of our patients.

We are thrilled to share that together, we have raised **\$11.1 million** toward our **\$12 million** goal for the new cancer center - just a step away from the finish line!

Thanks to your generosity, we've already helped over 7800 patients receive cancer care close to home this year. Your support has made it possible for 738 new patients to be seen at the cancer center and for 12 patients to access cutting-edge clinical trials & research in partnership with UCSF Health. This has been an incredible year thanks to your support!

Because of **YOU**, new and existing patients and their families will continue to receive the compassionate care they need during some of the most challenging times in their lives. Thank you for making such a profound difference in the lives of those we serve.

***Please consider making a gift to support cancer care in our community and helping us reach our \$12M goal.***

**Donate**

## Welcome New Foundation Trustees and Members

We extend a warm welcome to our new Officers, Trustees and Members joining us in 2025. Congratulations on your new roles!

**President:** Cathy Avon

**Past President:** Sophia Ahmad, Esq.

**Treasurer:** Craig A. Silcox

**Secretary:** Eileen Riener

**New Trustee:** Rob Avon

**New Members:** Jodie Aquino Sisk, Kelly Bair, Cora Benoun, Briana Holland, Paul Kelley, Dianne Martin, MD and Kimberly MacFarlane



Click [here](#) for the complete list of Foundation Officers and Trustees

## Foundation Updates



### The Spirit of Holiday Giving

Many generous donations were made in December. Community members Yvonne and Irma dropped off hand-knit blankets & slippers for cancer center patients. The Washington High School boys' basketball team donated hundreds of toys to Toys for Tots and coats and blankets to the Viola Blythe Community Center. This marks their second year of giving, and we appreciate the cheer and kindness they're spreading through these generous contributions. Marrow Link, a group bringing awareness to bone marrow transplants, donated care packages for patients in the cancer center. The packages included items such as lip balm, socks, hand cream and other items. Samik, a volunteer with Marrow Link shared, "We are a nonprofit organization dedicated to raising awareness about bone marrow transplants, blood diseases, and the importance of lifesaving donations".

**Thank you to our community for their**



### Charitable Giving - Estate Planning

Planned giving is a wonderful way to make an impactful contribution to a cause you care about while leaving a lasting legacy. With a planned gift to the Foundation, you can help ensure that Washington Health can continue to meet the evolving healthcare needs of our community, now and long into the future. You can choose a specialty that means the most to you, such as cancer care, maternal and child health, nursing education, and more. There are many ways to make a planned gift that offers benefits to you and your family, including wills, trusts, life insurance, retirement assets, or a one-time gift. The Legacy Society is composed of generous and forward-thinking individuals who have committed to the future of Washington Health and to the health and well-being of our community.

**Join us on Tuesday, March 11th at 5:00 pm in-person or on Zoom** for a free seminar to learn more about estate planning from estate attorney,

kindness and generosity to our patients.

Richard Schachtli. There is no ask or obligation of a commitment for those who attend. Register [here](#).



## 38th Annual Golf & Bocce Tournament

**Save The Date** for the 38th Annual Golf Tournament - **Monday, May 12th** at the Club at Castlewood in Pleasanton. Funds raised will help support equipment in the Hospital's operating rooms. Email [foundation@washingtonhealth.com](mailto:foundation@washingtonhealth.com) or click below, and we'll reach out with more details.

Click below if you would like to be contacted about the Golf Tournament

I'd like to participate!

I'd like to volunteer!



***"Nursing staff, housekeeping and food service all provided excellent care and concern for my needs while recovering"***

*-Recent Washington Health patient*

## Share your Gratitude

Honor a Caregiver Program invites individuals to honor a physician, nurse, or staff member at Washington Health. Gifts received give tribute to a staff member while also providing essential resources to the program or department of your choice. When a gift is made, the person you are honoring will be sent a letter sharing your gratitude while keeping the gift amount confidential. Any gift, big or small, makes a difference and lets our providers know how much their care and honoring the patient-first ethic is appreciated.

[Read More](#)



**Donate Now**

2000 Mowry Avenue,  
Fremont, CA 94538  
510.818.7350

[foundation@washingtonhealth.com](mailto:foundation@washingtonhealth.com)





Washington Health Foundation | 2000 Mowry Avenue | Fremont, CA 94538 US

[Unsubscribe](#) | [Update Profile](#) | [Constant Contact Data Notice](#)



Try email marketing for free today!